

5 Connect the appropriate CPU Power Connector (4 Pin, 8 Pin, 8+4 Pin, or 8+8 Pin EPS-12V) to the motherboard.

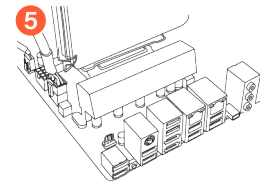

6 Connect the 6/6+2 Pin PCI-E cables to your graphics card(s). NOTE: The 8 Pin connector can be split into a 6+2 Pin. Do not attempt to plug a 8 Pin PCI-E cable into a 6-Pin connector without first detaching the two extra pins.

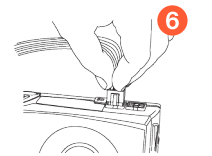

7 Connect the SATA power cables to all data drives or optical drives (e.g. hard drives, solid state drives, optical drives).



8 Connect the 4 Pin Molex Peripheral connectors for fans, pumps, legacy components and other devices and adapters.



9 Connect the AC power cord to your power supply and to the wall outlet. Check all connections to ensure a solid connection. Turn the power switch on the power supply to the ON position.

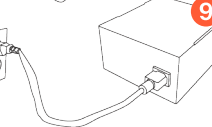

FAQs

Q: I see that there are more than four screw holes on the back of the power supply, but the package only includes four screws. Are some missing?

A: No. You will only need four screws to attach the ARESGAME power supply to the case. The power supply offers more than four holes in order to provide optimal compatibility for multiple case designs.

Q: What if I want to use power adapters for my video card(s)/motherboard/peripherals?

A: ARESGAME always recommends the use of direct power connections from the power supply to power all components.

Q: If I have an issue or a question, how can I get support?

A: All ARESGAME products are backed by top tier warranties as well as technical support.

Support can be reached by email at: support@aresgame.com.

Technical Specifications

Cable Specifications

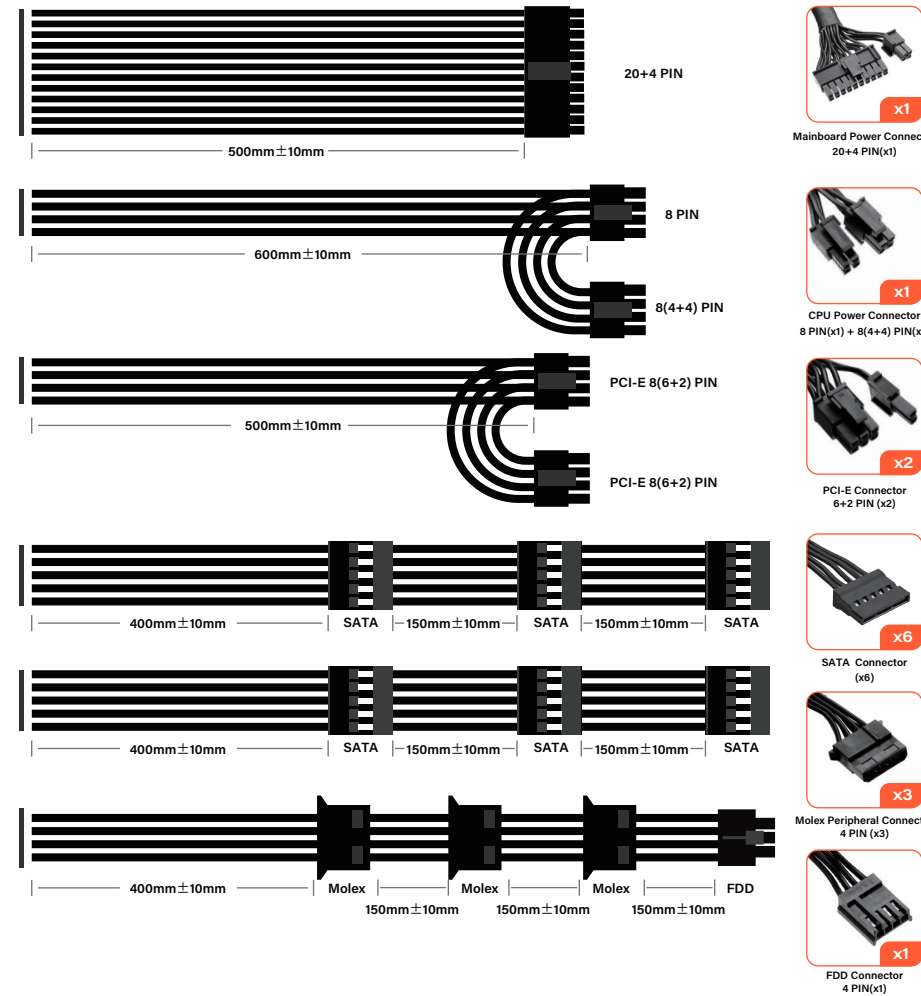

Output Specification

AC Input	100-240 VAC, 10-5A, 50-60Hz				
DC Output	+5V	+3.3V	+12V	-12V	+5Vsb
Max Output, A	20A	20A	49A	0.3A	2.5A
Combined, W	105W	588W		3.6W	12.5W
Output Power, P cont	650W @ 40°C / 104°F during full load				

Dimensions:
85mm (H) x 150mm(W) x 140mm (L)
3.3" (H) x 5.9" (W) x 5.5" (L)

Protections:
Over Voltage Protection (OVP), Under Voltage Protection(UVP), Short Circuit Protection(SCP), Over Power Protection(OPP)

Total Protection

-Over Voltage Protection

Voltage Source	Protection Point	
+3.3V	3.76V- 4.3V	-Over Power Protection Protection at 110%-150% full load
+5V	5.74V- 7.0V	-Short Circuit Protection Activated when any DC rails short circuited
+12V	13.4V- 15.6V	

Environments

Ambient temperature	
Operation	10°C to 45°C / 50°F to 113°F
Storage	-40°C to 70°C / -40°F to 158°F
Ambient humidity	
Operation	5% ~ 85% RH
Storage	5% ~ 95% RH

Troubleshooting

If the power supply does not work properly, please refer to the troubleshooting steps below:

1. Verify that the power cord is properly plugged into the AC outlet and the power supply.
2. Verify that the "I/O" switch on the power supply is in the "I" position.
3. Verify that all power connectors are properly connected to each device.
4. If you have a UPS device connected, verify that it is turned on and plugged in.

Should you require further assistance, please do not hesitate to email us at: support@aresgame.com



**AGV650
650watt**

User manual



Bronze power supply

Table of Contents

Components 1

Introduction 1

Safety Instructions & Disclaimer 2/3

Product Features 3

Installation 3

FAQs 4

Technical Specifications 5/6

Troubleshooting 7

Components



User Manual



Power Supply



Screws x4



AC Power Cord



Cable Ties x4

Introduction

Thank you for purchasing an ARESGAME AGV650 80 PLUS™ Bronze certified power supply. This high-quality product takes gamers’ needs as the primary design consideration and focuses on a cost-effective market. It is equipped with a 120mm hydraulic bearing silent fan to help dissipate the heat under a heavy load while maintaining a quiet performance. The AGV series is the best choice for stability and durability.



ARESGAME 650W BRONZE



Safety Instructions & Disclaimer

1. Please install following the instructions and installation guide. Incorrect installation may result in damage to the power supply or system components which may lead to serious injury.
2. Unauthorized non-professionals are strictly prohibited from disassembling the power supply. Unauthorized disassembly of this product will invalidate the ARESGAME warranty.
3. Only use the supplied cable or the original cable of the corresponding model purchased directly from the ARESGAME official store. Using incorrect cables may cause product disfunction which may lead to fire and damage. Likewise, if the power supply needs to connect to modular cables, use only cables that are specifically designed to be compatible with your specific power supply model. Using other cables may not be compatible with the leads and may result in serious damage to the system and power supply.
4. Do not place this product close to any source of heat such as radiators, heater holes.
5. Keep the interior of the PC Case clean and maintain appropriate heat dissipation condition for the power supply.
6. It is not recommended to overload the power supply.
7. Use power strips that meet safety standards to avoid short circuits.
8. This power supply can only be used to power the PC, and it is not suitable to use for other purposes.
9. To ensure the stable operation of the PC system and the maximum service life of the power supply, please be clear about the power required by your PC and other accessories in advance. It is recommended to reserve 15-20% of the power margin for the selected power supply, which should not be lower than the power recommended by the official accessories.
10. For those unauthorized ARESGAME power supplies purchased through unofficial channels, ARESGAME do not assume any after-sales responsibility. (State: For ARESGAME power supplies sold by authorized distributors and agents, please contact the agent seller directly to deal with related after-sales issues.)
11. For the additional services, accessories and gifts promised by the distributors and agents themselves, the original distributors and agents are responsible for them.
12. For products that are not covered by the warranty, ARESGAME will not be responsible for any services. Counterfeit products are also not covered by the warranty.

Exclusion Clauses

The warranty of this product does not cover problems or damage caused by the following reasons, including but not limited to:

1. The product's faulty parts have exceeded the free warranty period.
2. Failure or damage caused by the use of pirated or other unauthorized software, non-standard or unpublished software.
3. Wear and tear by normal use. Damage caused by changes in the appearance of the product (accidental or otherwise), but does not affect on the operation and performance of the product, including but not limited to rust, color change, texture decoration, natural wear and the gradual aging of the product, such as normal LED lights weakened or dimmed due to use or wear.

Product Features

4. Any damage caused by modification, accident, disassembly, improper use or unauthorized repair.
5. Any damage caused by improper installation, operation, cleaning, including all behaviors that do not follow the product instructions.
6. Damage caused by force majeure such as natural disasters (including but not limited to earthquakes, floods, rainstorms, typhoons, lightning strikes, fires).
7. Damage caused by war, terrorist activity, nuclear accident.
8. Failure or damage caused by accidental factors or human factors (including but not limited to computer viruses, operating errors, fluid, scratches, handling, bumps, improper moves of the plug, foreign objects, rodents, pests, etc.)

STABLE POWER

The AGV650 has outstanding electrical performance with an ultra-stable voltage and extremely clean power output. This can help you achieve the highest possible overclock, if desired, and provide very stable and reliable power to all components. The AGV650 also provides up to 85% efficiency for 115VAC and 88% efficiency for 220VAC-240VAC and is 80 PLUS™ Bronze certified.

TOP QUALITY PROTECTIONS

The AGV650 comes equipped with the most comprehensive protection possible, including Over Voltage Protection (OVP), Under Voltage Protection (UVP), Over Power Protection (OPP), and Short Circuit Protection (SCP). This product is also covered by a 5-year warranty and ARESGAME’s legendary customer service and support.

Installation

1. Remove your existing power supply and cables, if you have not yet done so.
2. Take out the new power supply from its packaging.
3. Use the four screws provided in the package contents to install the power supply into your computer. NOTE: It is recommended to install the power supply with the fan facing downwards. However, if your case places the power supply at the bottom of the case and there are no ventilation holes available, it may be best to install the power supply with the fan facing upwards for greater efficiency and reliability.
4. Connect the Main Power Connector (20+4 Pin) ATX cable to the motherboard.

